

# The Seattle Community Farm & Good Food Project

*Providing Healthy Food, Garden Education and Growing Opportunities for our Community*

## Seattle Community Farm

- Will turn unused urban land into a farm for local residents and volunteers, with the produce going to low-income residents, the Rainier Valley food bank, Teen and Childcare Programs.
- Is modeling a shared garden environment rather than individual plots.
- Will have staff on-site managing operations and coordinating volunteers; residents who volunteer will receive fresh produce.
- Will help teach children and youth about gardening and eating healthy foods.
- Will respect the ethnic, racial and cultural richness of Rainier Valley.
- Is a partnership among Solid Ground, Seattle Housing Authority & the P-Patch Program.

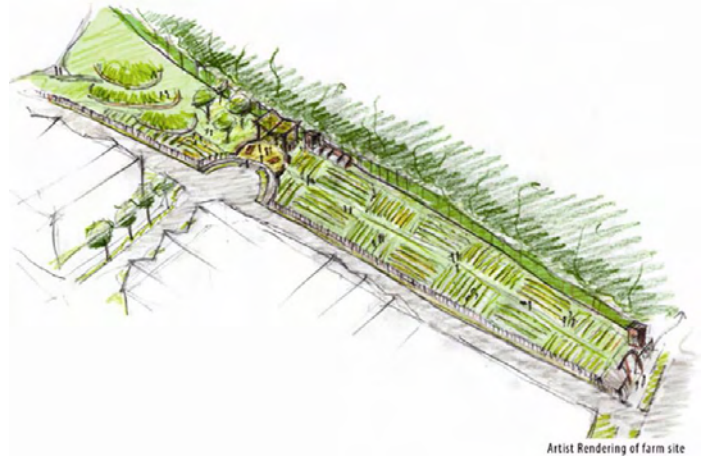

## Expected Timeline

Nov 09 - Feb 2010	Talking with Rainier Valley residents and service providers about the concept, soliciting concerns and visionary ideas.
March - May 2010	Design meetings and design work
May - June 2010	Land terracing, construction and community work parties
June - July 2010	First seeds planted
September 2010	Official opening and community celebration

## How can you be involved?

Design: From your suggestions offered at the March 3<sup>rd</sup> design meeting, the volunteer Landscape Architect, Eric Higbee will create three options. In April, we will ask for your feedback and this will help create a final design that we will share with you before construction.

Create: Join coordinated work parties to lay paths, dig garden beds, haul compost, plant and craft art for the site.

Garden: Plant, weed, harvest, eat and learn together. Produce will be shared with volunteers who need it and with the Rainier Valley food bank and other programs. There is no fee to participate, just a dedication and willingness to work together.

---

## The Seattle Community Farm and Good Food Project

is creating an urban farm at Rainier Vista to grow food for hungry people while providing garden education, market garden & retail produce opportunities in Rainier Valley, the Central Area & Delridge.

For more information on the Seattle Community Farm  
[urbanfarm@solid-ground.org](mailto:urbanfarm@solid-ground.org)